



5 Bedroom - 2 1/2 Baths - 2nd Floor Master Suite - 2,578 sq ft Living Area

**LITZENBERGER**

Website: [www.rkcustomhomes.com](http://www.rkcustomhomes.com)

**R&K**  
Custom Homes

# LITZENBERGER - Living Area 2,578 sq ft

Website: [www.rkcustomhomes.com](http://www.rkcustomhomes.com)

**FIRST FLOOR** - Living Area 1,172 Sq Ft

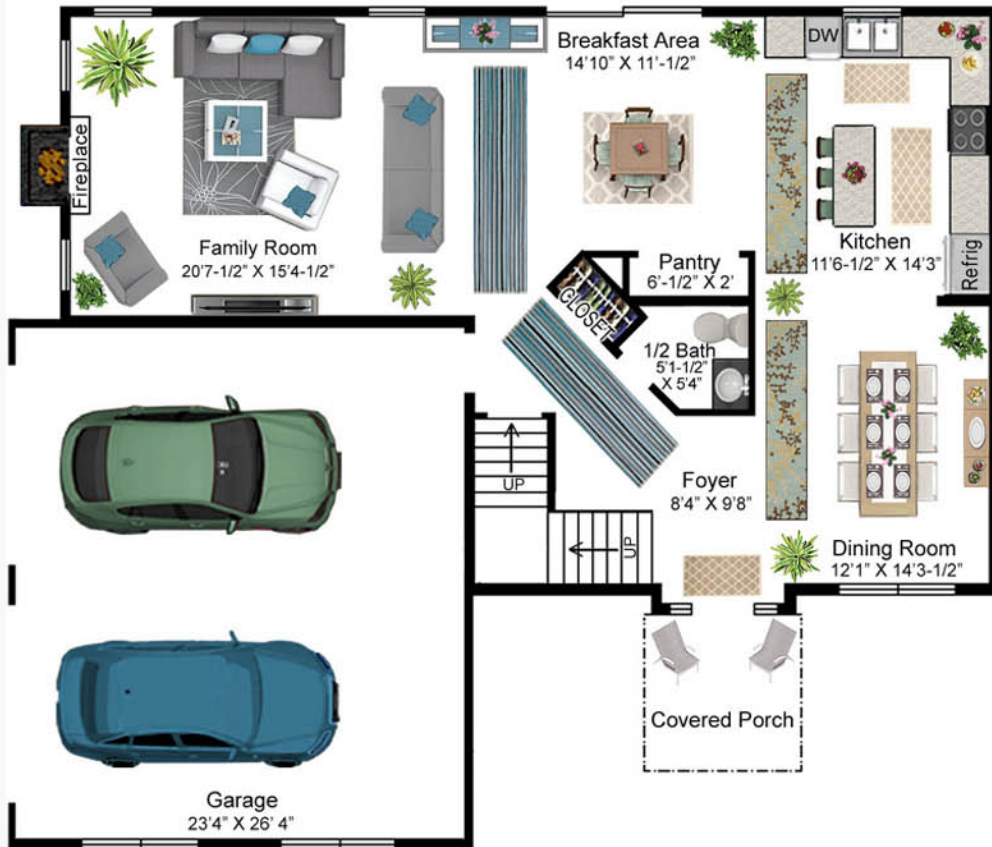

**SECOND FLOOR** - Living Area 1,406 Sq Ft



- ◆ Foyer Overlooks Dining Room
- ◆ Spacious Open Concept for Kitchen, Breakfast Area & Family Room
- ◆ 2nd Floor Laundry
- ◆ 2 Car - Side Entry Garage

- ◆ 5 Bedrooms
- ◆ 2 1/2 Baths
- ◆ Master Suite with 2 Walk-In Closets
- ◆ Spacious Master Bath
- ◆ Wide Staircase & Hallways

All sizes & dimensions are approximate. Window sizes, shapes & locations may vary. In the interest of continued improvement, R & K Custom Homes reserves the right to make modifications including, but not limited to features, designs, facades & pricing. Actual facades may vary slightly. Contract & specifications take precedence over the brochure.

**R&K**  
Custom Homes